

HOW TO MEASURE FOR A SWING OUT DOOR WITH SLOPED INLINE PANEL

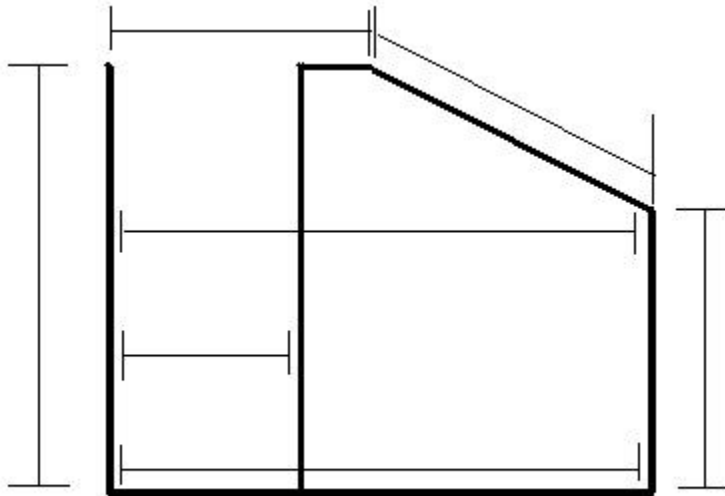

IMPORTANT: ONLY USE FINISHED CENTERLINE DIMENSIONS.

MEASURE OVERALL WIDTH AT BOTTOM, MIDDLE, AND TOP
(AT BEGINNING & END OF SLOPE.)

MEASURE DOOR WIDTH SEPARATELY.
(NOTE: DOOR NOT TO EXCEED 36", PANEL NOT LESS THAN 7").

MEASURE DISTANCE OF SLOPE.

MEASURE HEIGHT FROM TOP OF THRESHOLD TO
DESIRED OVERALL HEIGHT.

MEASURE HEIGHT FROM TOP OF THRESHOLD TO BEGINNING OF SLOPE.

PROVIDE HINGE LOCATION, (LEFT OR RIGHT, OFF WALL OR PANEL).